

REVISIONS:

NO.	DATE	REMARKS	BY
			CHK

HASTINGS-ON-HUDSON
7 MAPLE AVE
HASTINGS-ON-HUDSON, NY 10706

NOT APPROVED FOR CONSTRUCTION

PROJECT # : 17-01-2680
DRAWN BY: JC
CHECKED BY: JS
ORIGINAL DATE: 03-01-2018
DRAWING SCALE: 1"=20'
FILE NAME: 17-01-2680 Traffic Calming_Proposed
Updates - NEW6_recover.dwg

ON-CALL TRAFFIC ENGINEERING SERVICES

TOC#1
STREET SAFETY AND TRAFFIC
CALMING IMPROVEMENTS

NEW YORK LICENSE NUMBER
NY BUSINESS AUTHORIZATION NO. 0010052

SHEET TITLE:
JAMES STREET BETWEEN
CROSSBAR ROAD AND
TOMPKINS AVENUE

DRAWING NO.	TC-1
SHEET NO.	1 OF 19

REVISION 1

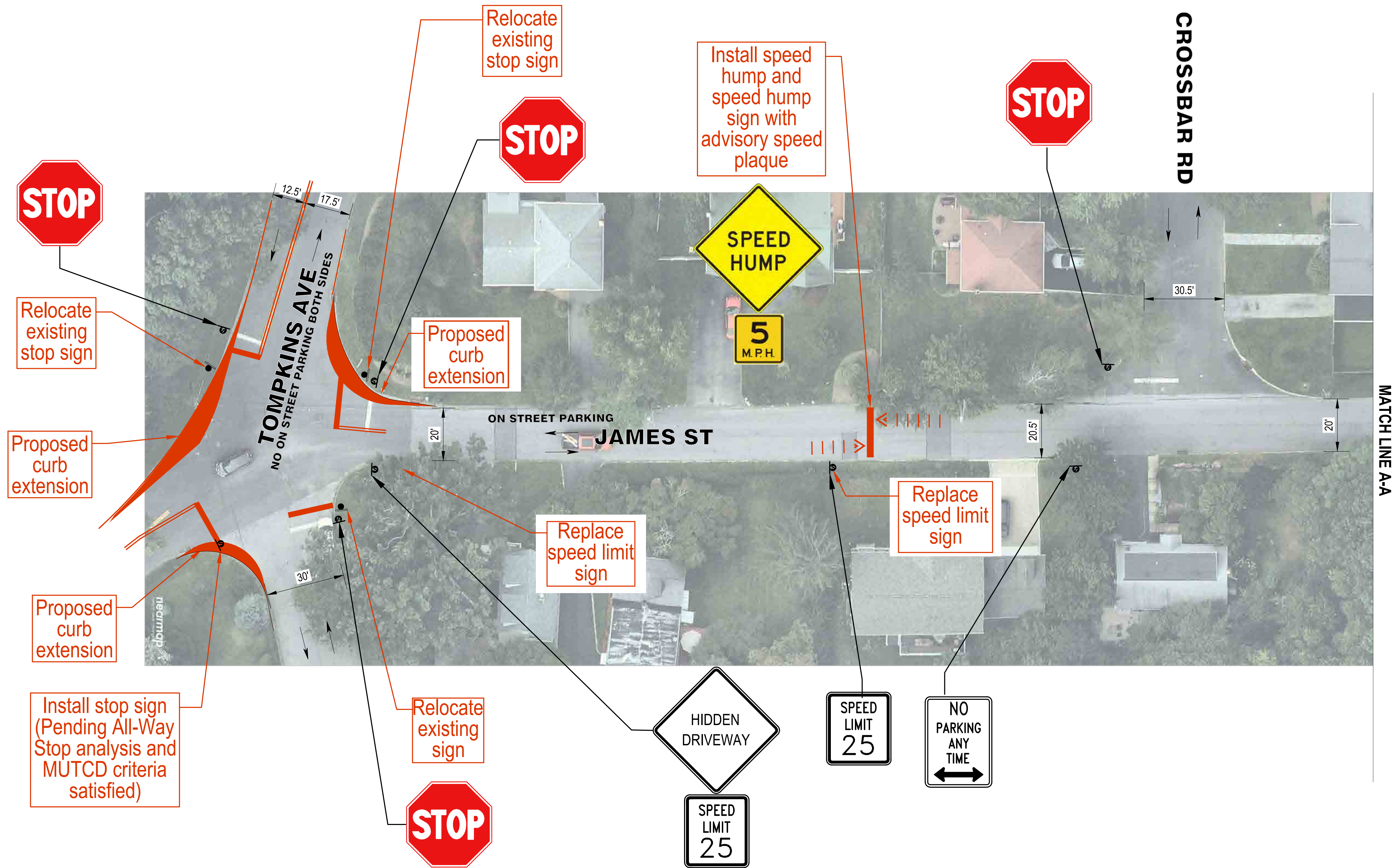

FOR PLANNING PURPOSES ONLY
NOT FOR DESIGN OR CONSTRUCTION

SCALE

(IN FEET)
1 inch = 20 ft.

Sam Schwartz

NEW YORK • NEW JERSEY • CHICAGO
WASHINGTON D.C. • TAMPA • LOS ANGELES

REVISIONS:

NO.	DATE	REMARKS	BY CHK

HASTINGS-ON-HUDSON
7 MAPLE AVE
HASTINGS-ON-HUDSON, NY 10706

NOT APPROVED FOR CONSTRUCTION

PROJECT # : 17-01-2680
DRAWN BY: JC
CHECKED BY: JS
ORIGINAL DATE: 03-01-2018
DRAWING SCALE: 1"=20'
FILE NAME: 17-01-2680 Traffic Calming_Proposed
Updates - NEW6_recover.dwg

ON-CALL TRAFFIC ENGINEERING SERVICES

TOC#1
STREET SAFETY AND TRAFFIC
CALMING IMPROVEMENTS

NEW YORK LICENSE NUMBER
NY BUSINESS AUTHORIZATION NO. 0010052

DRAWING NO.	TC-2
SHEET NO.	2 OF 19

REVISION 1

MATCH LINE A-A

MATCH LINE TC-3

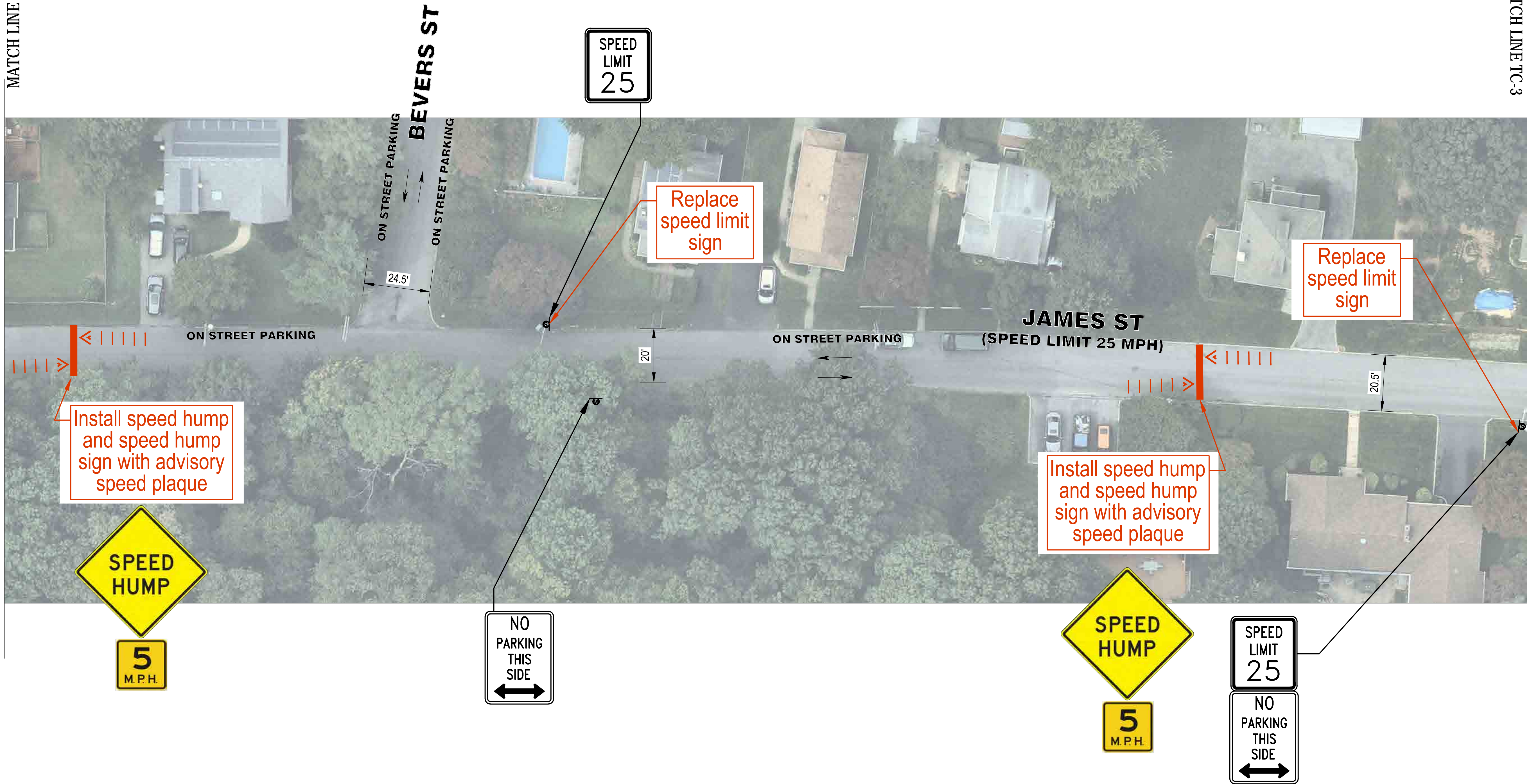

FOR PLANNING PURPOSES ONLY
NOT FOR DESIGN OR CONSTRUCTION

SCALE

(IN FEET)
1 inch = 20 ft.

TB REV 10-26-2016 1847:02:44PM aspernce
 \\W0020\PROJECTS\17-01-2680 HASTINGS-ON-HUDSON TRAFFIC ENGINEERING SERVICES\GRAPHICS\CAD FILES\17-01-2680 TRAFFIC CALMING_PROPOSED UPDATES - NEWB_RECOVER >>> LAYOUT: 2

MATCH LINE TC-2

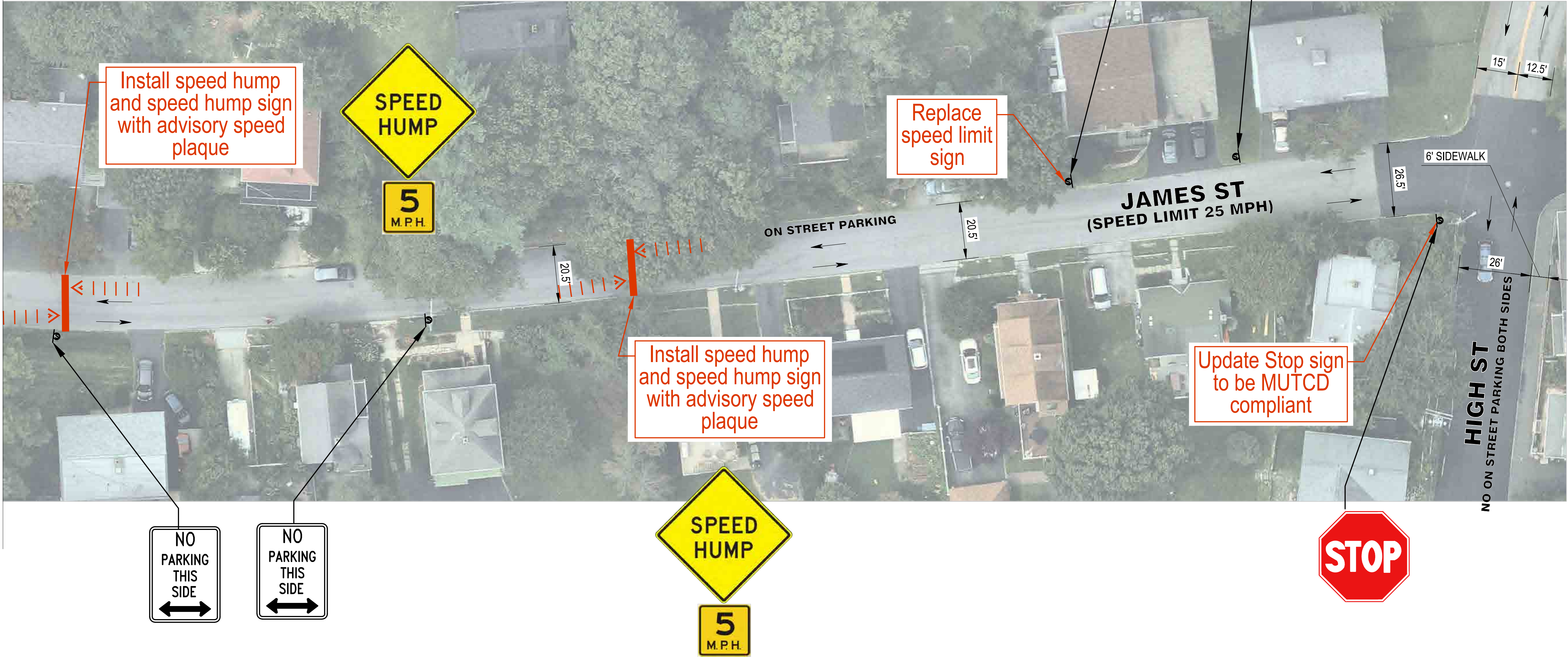

FOR PLANNING PURPOSES ONLY
NOT FOR DESIGN OR CONSTRUCTION

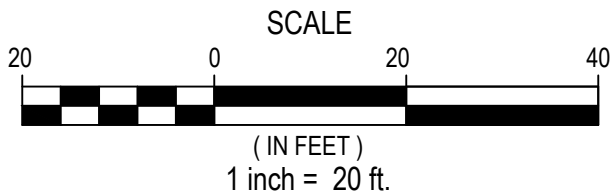

PREPARED BY:



NEW YORK • NEW JERSEY • CHICAGO
WASHINGTON D.C. • TAMPA • LOS ANGELES

322 EIGHTH AVENUE
5TH FLOOR
NEW YORK, NY 10001
P: (212) 598-9010 ~ FAX: (212) 598-9148

REVISIONS:

NO.	DATE	REMARKS	BY
			CHK

CLIENT:

HASTINGS-ON-HUDSON
7 MAPLE AVE
HASTINGS-ON-HUDSON, NY 10706

NOT APPROVED FOR CONSTRUCTION

PROJECT #: 17-01-2680
DRAWN BY: JC
CHECKED BY: JS
ORIGINAL DATE: 03-01-2018
DRAWING SCALE: 1"=20'
FILE NAME: 17-01-2680 Traffic Calming_Proposed Updates - NEW6_recover.dwg

PROJECT:

ON-CALL TRAFFIC
ENGINEERING SERVICES

TOC#1
STREET SAFETY AND TRAFFIC
CALMING IMPROVEMENTS

PROFESSIONAL ENGINEER:

NEW YORK LICENSE NUMBER
NY BUSINESS AUTHORIZATION NO. 0010052

SHEET TITLE:
JAMES STREET BETWEEN
CROSSBAR ROAD AND
TOMPKINS AVENUE

DRAWING NO. TC-3
SHEET NO. 3 OF 19

REVISION 1

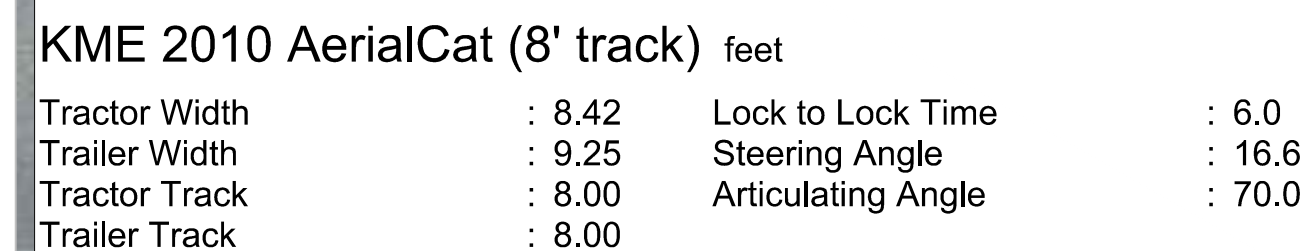

ON STREET PARKING
JAMES ST

TOMPKINS AVE
NO ON STREET PARKING BOTH SIDES

FOR PLANNING PURPOSES ONLY
NOT FOR DESIGN OR CONSTRUCTION



Sam Schwartz

NEW YORK • NEW JERSEY • CHICAGO

322 EIGHTH AVENUE
5TH FLOOR
NEW YORK, NY 10001
P: (212) 598-9010 ~ FAX: (212) 598-9148

NO.	DATE	REMARKS	BY CHK

HASTINGS-ON-HUDSON
7 MAPLE AVE
HASTINGS-ON-HUDSON, NY 10706

NOT APPROVED FOR CONSTRUCTION

PROJECT #: 17-01-2680
DRAWN BY: JC
CHECKED BY: JS
ORIGINAL DATE: 03-01-2018
DRAWING SCALE: 1"=10'
FILE NAME: 17-01-2680 Traffic Calming_Proposed
Updates - NEW6 recover.dwg

ON-CALL TRAFFIC ENGINEERING SERVICES

TOC#1
STREET SAFETY AND TRAFFIC
CALMING IMPROVEMENTS

NEW YORK LICENSE NUMBER
NY BUSINESS AUTHORIZATION NO. 0010052

JAMES STREET AND
TOMPKINS AVENUE
FIRE TRUCK TURNS

DRAWING NO.	TC-5
SHEET NO.	5 OF 19

REVISION 1

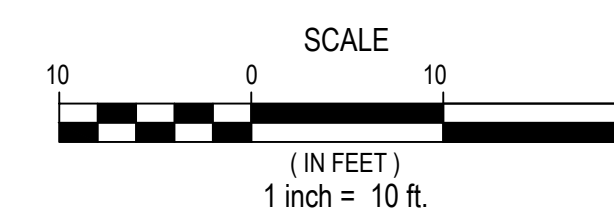

TB REV 10-26-2016 18417:02:44PM cspence
 \NYDC02\PROJECTS\17-01-2680 HASTINGS-ON-HUDSON TRAFFIC ENGINEERING SERVICES\GRAPHICS\CAD FILES\17-01-2680 TRAFFIC CALMING PROPOSED UPDATES - NEW6 RECOVER >>>> LAYOUT: 5

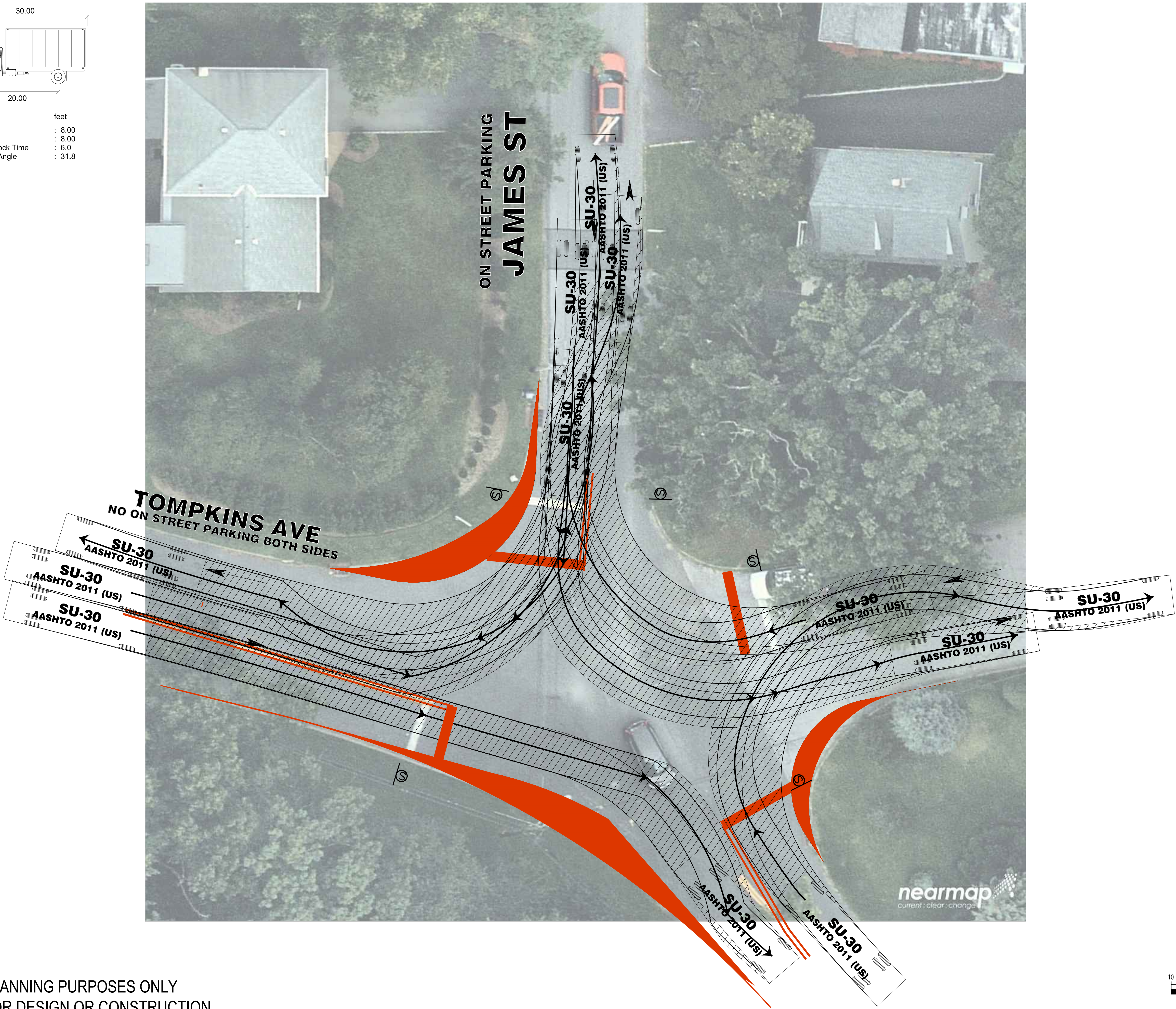
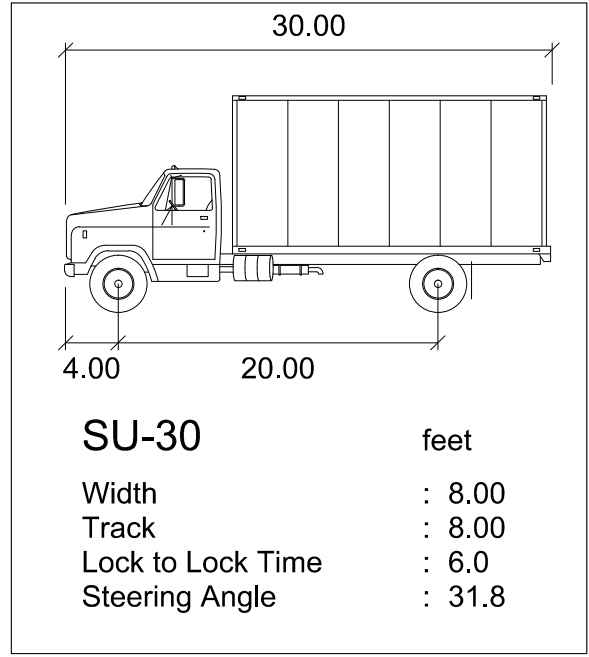

FOR PLANNING PURPOSES ONLY
NOT FOR DESIGN OR CONSTRUCTION

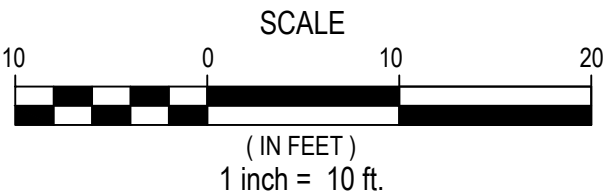

PREPARED BY:



NEW YORK • NEW JERSEY • CHICAGO
WASHINGTON D.C. • TAMPA • LOS ANGELES

322 EIGHTH AVENUE
5TH FLOOR
NEW YORK, NY 10001
P: (212) 598-9010 ~ FAX: (212) 598-9148

REVISIONS:

NO.	DATE	REMARKS	BY CHK

CLIENT:

HASTINGS-ON-HUDSON
7 MAPLE AVE
HASTINGS-ON-HUDSON, NY 10706

NOT APPROVED FOR CONSTRUCTION

PROJECT # : 17-01-2680
DRAWN BY: JC
CHECKED BY: JS
ORIGINAL DATE: 03-01-2018
DRAWING SCALE: 1"=10'
FILE NAME: 17-01-2680 Traffic Calming_Proposed Updates - NEW6_recover.dwg

PROJECT:

ON-CALL TRAFFIC
ENGINEERING SERVICES

TOC#1
STREET SAFETY AND TRAFFIC
CALMING IMPROVEMENTS

PROFESSIONAL ENGINEER:

NEW YORK LICENSE NUMBER
NY BUSINESS AUTHORIZATION NO. 0010052

SHEET TITLE:

JAMES STREET AND
TOMPKINS AVENUE
SU-30 TRUCK TURNS

DRAWING NO. TC-6
SHEET NO. 6 OF 19

REVISION 1

James Street One-Way Cross Section

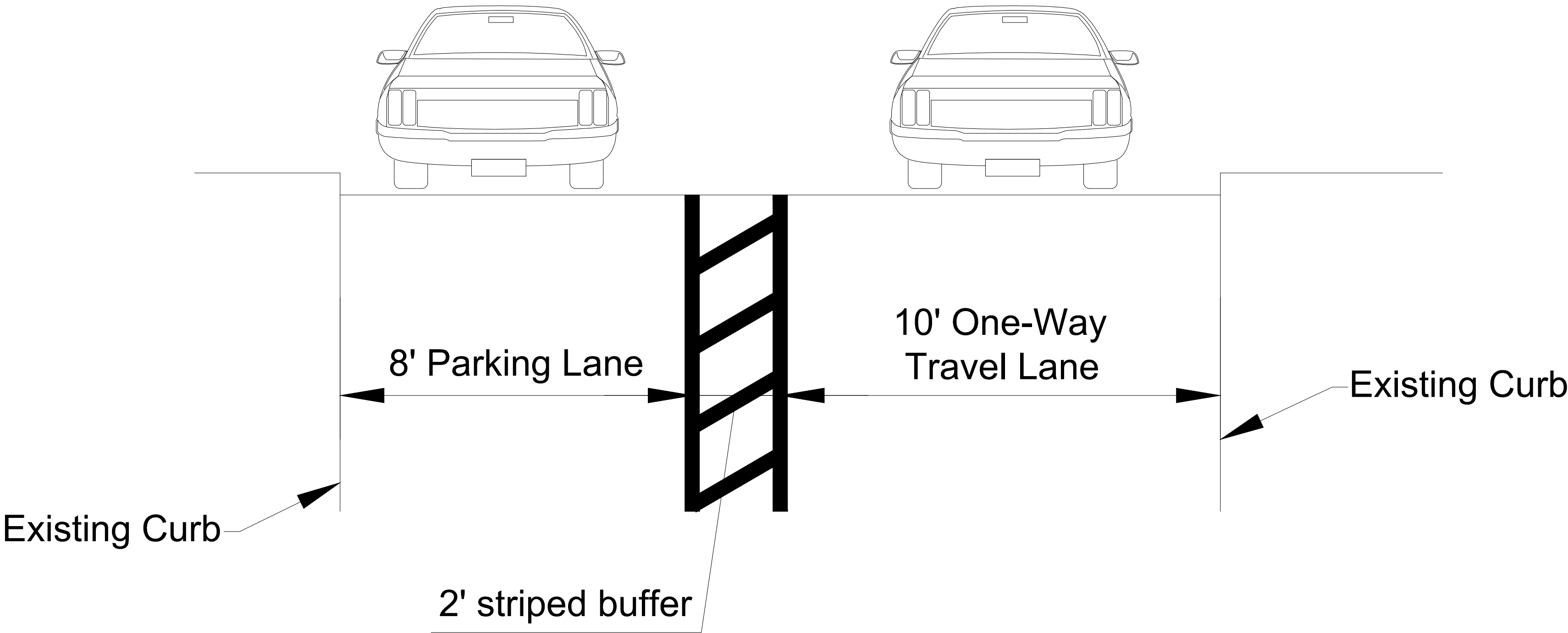

FOR PLANNING PURPOSES ONLY
NOT FOR DESIGN OR CONSTRUCTION

PREPARED BY:



WASHINGTON D.C. • TAMPA • LOS ANGELES

322 EIGHTH AVENUE
5TH FLOOR
NEW YORK, NY 10001
P: (212) 598-9010 ~ FAX: (212) 598-9148

REVISIONS:

NO.	DATE	REMARKS	BY
			CHK

CLIENT:

HASTINGS-ON-HUDSON
7 MAPLE AVE
HASTINGS-ON-HUDSON, NY 10706

NOT APPROVED FOR CONSTRUCTION

PROJECT #: 17-01-2680
DRAWN BY: JC
CHECKED BY: JS
ORIGINAL DATE: 03-01-2018
DRAWING SCALE: N.T.S.
FILE NAME: 17-01-2680 Traffic Calming_Proposed
Updates - NEW6_recover.dwg

PROJECT:

ON-CALL TRAFFIC ENGINEERING SERVICES

TOC#1
STREET SAFETY AND TRAFFIC
CALMING IMPROVEMENTS

PROFESSIONAL ENGINEER:

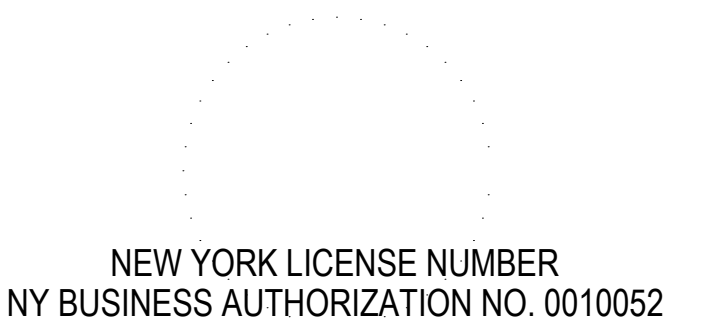

SHEET TITLE:
JAMES STREET
PROPOSED ONE-WAY
CROSS SECTION

DRAWING NO.	TC-7
SHEET NO.	7 OF 19

REVISION 1

1" 0 1" 2"

SCALE

NOT TO SCALE

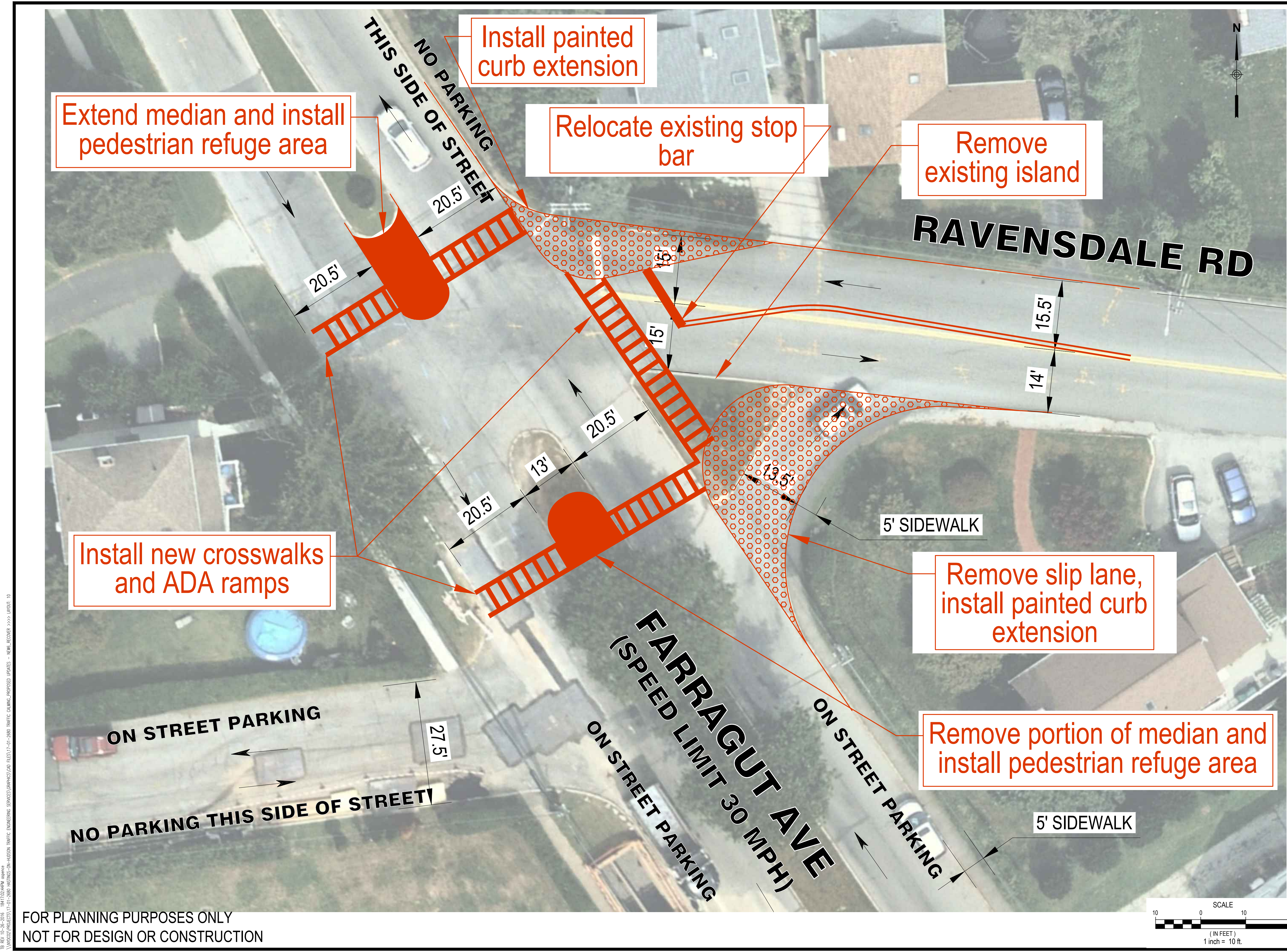

PREPARED BY:



NEW YORK • NEW JERSEY • CHICAGO
WASHINGTON D.C. • TAMPA • LOS ANGELES

322 EIGHTH AVENUE
5TH FLOOR
NEW YORK, NY 10001
P: (212) 598-9010 ~ FAX: (212) 598-9148

REVISIONS:

NO.	DATE	REMARKS	BY	CHK

CLIENT:

HASTINGS-ON-HUDSON
7 MAPLE AVE
HASTINGS-ON-HUDSON, NY 10706

NOT APPROVED FOR CONSTRUCTION

PROJECT #: 17-01-2680
DRAWN BY: JC
CHECKED BY: JS
ORIGINAL DATE: 03-01-2018
DRAWING SCALE: 1"=10'
FILE NAME: 17-01-2680 Traffic Calming_Proposed Updates - NEW6_recover.dwg

PROJECT:

ON-CALL TRAFFIC
ENGINEERING SERVICES

TOC#1
STREET SAFETY AND TRAFFIC
CALMING IMPROVEMENTS

PROFESSIONAL ENGINEER:

NEW YORK LICENSE NUMBER
NY BUSINESS AUTHORIZATION NO. 0010052

SHEET TITLE:

RAVENSDALE ROAD AND
FARRAGUT AVENUE
PROPOSED IMPROVEMENTS

DRAWING NO. TC-10
SHEET NO. 10 OF 19

REVISION 1

FOR PLANNING PURPOSES ONLY
NOT FOR DESIGN OR CONSTRUCTION

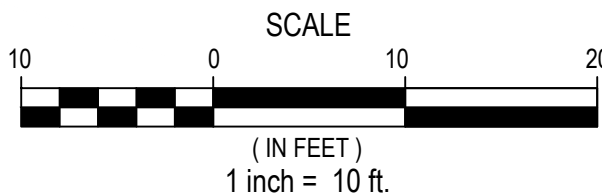

17-REV 10-26-2018 15:07:24 NEW 17-01-2680 TRAFFIC CALMING PROPOSED IMPROVEMENTS - NEW6_RECOVER.dwg



SCALE

(IN FEET)
1 inch = 10 ft.

NEW YORK • NEW JERSEY • CHICAGO
WASHINGTON D.C. • TAMPA • LOS ANGELES

REVISION 1

Sam Schwartz

NEW YORK • NEW JERSEY • CHICAGO
WASHINGTON D.C. • TAMPA • LOS ANGELES

REVISIONS:

NO.	DATE	REMARKS	BY
			CHK

HASTINGS-ON-HUDSON
7 MAPLE AVE
HASTINGS-ON-HUDSON, NY 10706

NOT APPROVED FOR CONSTRUCTION

PROJECT # : 17-01-2680
DRAWN BY: JC
CHECKED BY: JS
ORIGINAL DATE: 03-01-2018
DRAWING SCALE: 1"=10'
FILE NAME: 17-01-2680 Traffic Calming_Proposed
Updates - NEW6_recover.dwg

ON-CALL TRAFFIC ENGINEERING SERVICES

TOC#1
STREET SAFETY AND TRAFFIC
CALMING IMPROVEMENTS

NEW YORK LICENSE NUMBER
NY BUSINESS AUTHORIZATION NO. 0010052

SHEET TITLE:
RAVENSDALE ROAD AND
BRANDFORD AVENUE
PROPOSED IMPROVEMETNS

DRAWING NO.	TC-13
SHEET NO.	13 OF 19

REVISION 1

Add crosswalk

Extend sidewalk at corner and add ADA ramp

Add sidewalk and ADA ramp

Install in crosswalk "Yield Here to Pedestrians In Crosswalk" signage

Install "Yield Here to Pedestrians" signage

Relocate
crosswalk
further
west

Install "Yield Here to Pedestrians" signage

Extend sidewalk at corner and add ADA ramp

Add crosswalk
(typ.)

Relocate
stop bar
and stop
sign south

Install in crosswalk "Yield Here to Pedestrians In Crosswalk" signage

Add sidewalk and ADA ramp

FOR PLANNING PURPOSES ONLY
NOT FOR DESIGN OR CONSTRUCTION

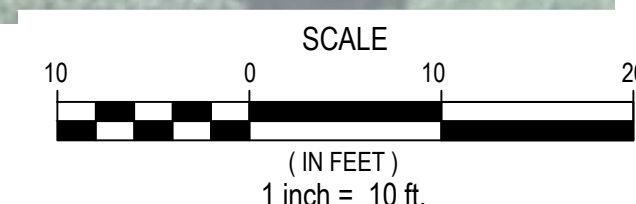

TB REV 10-26-2016 18417:02:44PM cspence
 \AWD000\PROJECTS\17-01-0680 HASTINGS-ON-HUDSON TRAFFIC ENGINEERING SERVICES\GRAPHICS\CAD FILES\17-01-0680 TRAFFIC CALMING PROPOSED UPDATES - NEW6.RECOVER >>>> LAYOUT.13

17-REV 10-26-2016 15:17:24 NEW 17-01-2680 TRAFFIC CALMING, PROPOSED IMPROVEMENTS - NEW6_RECOVER.dwg
17-01-2680 TRAFFIC CALMING, PROPOSED IMPROVEMENTS - NEW6_RECOVER.dwg

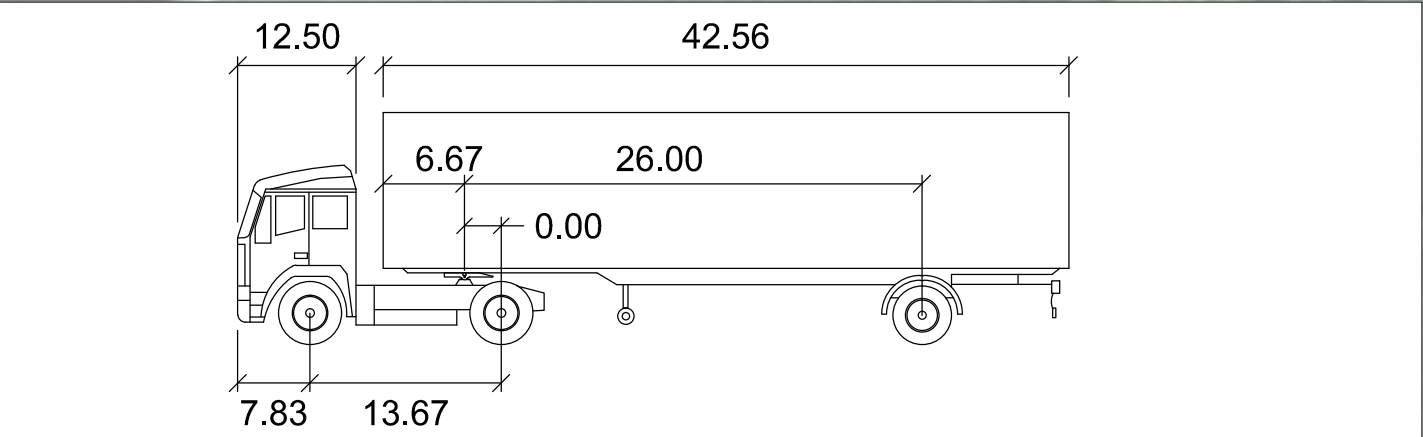
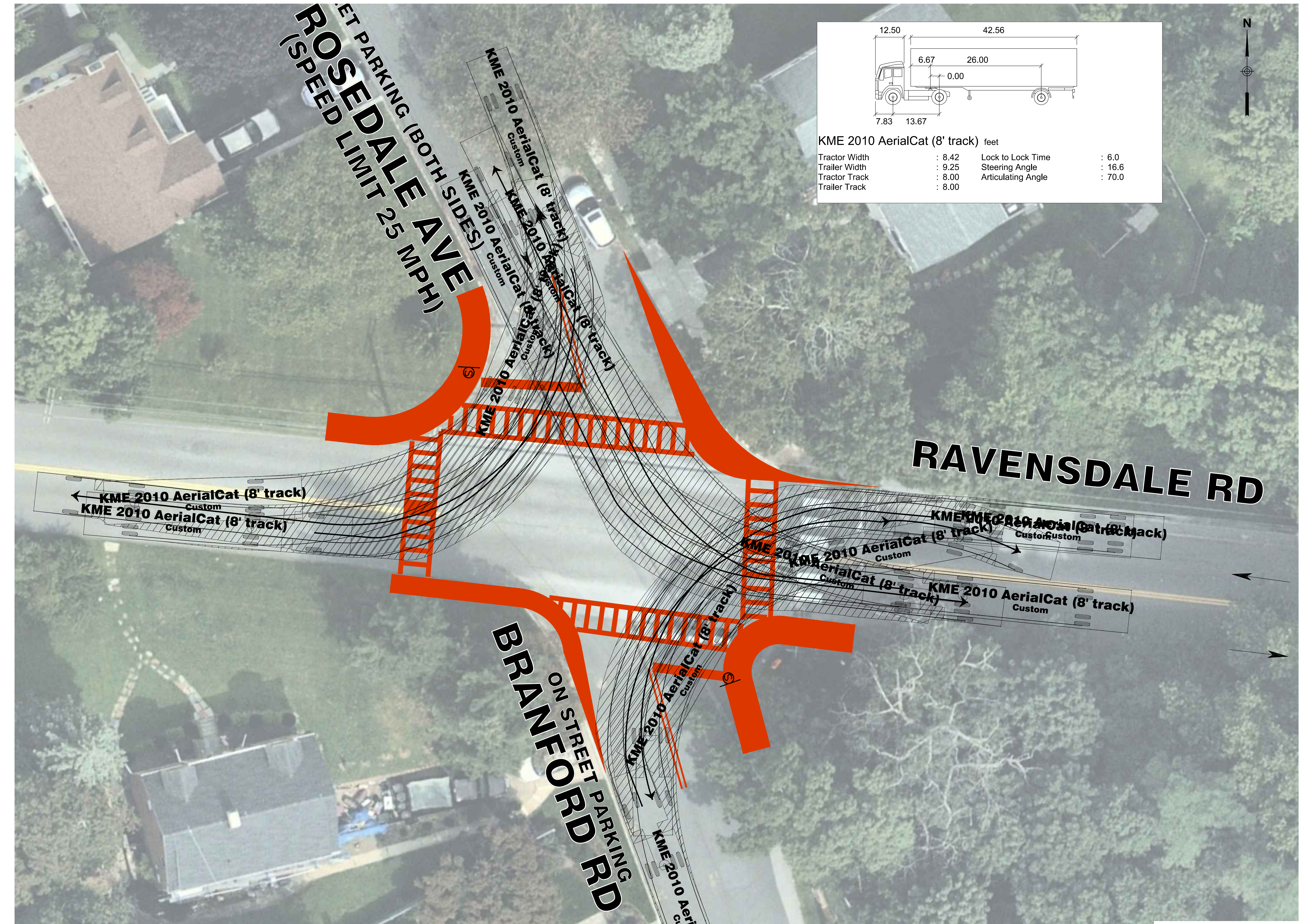

KME 2010 AerialCat (8' track) feet			
Tractor Width	: 8.42	Lock to Lock Time	: 6.0
Trailer Width	: 9.25	Steering Angle	: 16.6
Tractor Track	: 8.00	Articulating Angle	: 70.0
Trailer Track	: 8.00		



PREPARED BY:



NEW YORK • NEW JERSEY • CHICAGO
WASHINGTON D.C. • TAMPA • LOS ANGELES

322 EIGHTH AVENUE
5TH FLOOR
NEW YORK, NY 10001
P: (212) 598-9010 ~ FAX: (212) 598-9148

REVISIONS:

NO.	DATE	REMARKS	BY
			CHK

CLIENT:

HASTINGS-ON-HUDSON
7 MAPLE AVE
HASTINGS-ON-HUDSON, NY 10706

NOT APPROVED FOR CONSTRUCTION

PROJECT #: 17-01-2680
DRAWN BY: JC
CHECKED BY: JS
ORIGINAL DATE: 03-01-2018
DRAWING SCALE: 1"=10'
FILE NAME: 17-01-2680 Traffic Calming_Proposed Updates - NEW6_recover.dwg

PROJECT:

ON-CALL TRAFFIC
ENGINEERING SERVICES

TOC#1
STREET SAFETY AND TRAFFIC
CALMING IMPROVEMENTS

PROFESSIONAL ENGINEER:

NEW YORK LICENSE NUMBER
NY BUSINESS AUTHORIZATION NO. 0010052

SHEET TITLE:
RAVENSDALE ROAD AND
BRANDFORD AVENUE
FIRE TRUCK TURNS

DRAWING NO. TC-14
SHEET NO. 14 OF 19

REVISION 1

FOR PLANNING PURPOSES ONLY
NOT FOR DESIGN OR CONSTRUCTION

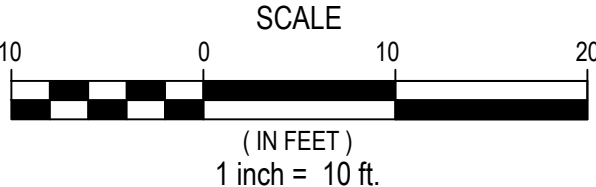

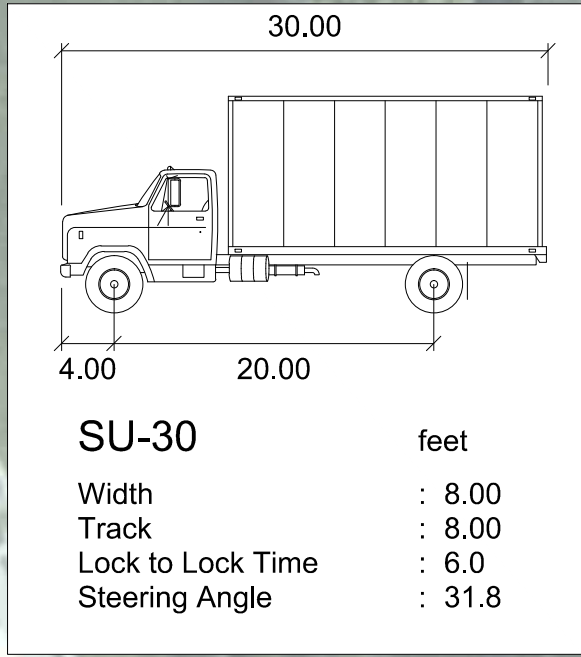

Sam Schwartz

NEW YORK • NEW JERSEY • CHICAGO
WASHINGTON D.C. • TAMPA • LOS ANGELES

322 EIGHTH AVENUE
5TH FLOOR
NEW YORK, NY 10001
P: (212) 598-9010 ~ FAX: (212) 598-9148

NO.	DATE	REMARKS	BY CHK

HASTINGS-ON-HUDSON
7 MAPLE AVE
HASTINGS-ON-HUDSON, NY 10706

NOT APPROVED FOR CONSTRUCTION

PROJECT # : 17-01-2680
DRAWN BY: JC
CHECKED BY: JS
ORIGINAL DATE: 03-01-2018
DRAWING SCALE: 1"=10'
FILE NAME: 17-01-2680 Traffic Calming_Proposed
Updates - NEW6_recover.dwg

ON-CALL TRAFFIC ENGINEERING SERVICES

TOC#1
STREET SAFETY AND TRAFFIC
CALMING IMPROVEMENTS

NEW YORK LICENSE NUMBER
NY BUSINESS AUTHORIZATION NO. 0010052

SHEET TITLE:
RAVENSDALE ROAD AND
BRANDFORD AVENUE
SU-30 TRUCK TURNS

DRAWING NO.	TC-15
SHEET NO.	15 OF 19

REVISION 1

FOR PLANNING PURPOSES ONLY
NOT FOR DESIGN OR CONSTRUCTION

SCALE



(IN FEET)
1 inch = 10 ft.

TB REV 10-26-2016 1847:02:44PM esperece
 \\W0002\PROJECTS\17-01-2680 HISTINGS-ON-HUDSON TRAFFIC ENGINEERING SERVICES\GRAPHICS\DW FILES\17-01-2680 TRAFFIC CLUMPING_PROPOSED UPDATES - NEWING_RECOVER.dwg LAYOUT: 15

Convert head-in angle parking
to reverse angle parking
Note: 4 parking spaces would
be lost and existing ADA
space to be relocated

7' SIDEWALK

Install curb extension

Install in crosswalk "Yield Here to Pedestrians in Crosswalk" signage



SOUTHSIDE AVE
ON STREET PARKING
(BOTH SIDES)

IN
WALK

ON STREET PARKING

14.5'

MAPLE AVE
ON STREET PARKING

Install new crosswalks and ADA ramps

Relocate stop sign and stop bar



6.5' SIDEWALK

An aerial photograph of a street intersection. A large white rectangular sign is mounted on a pole, displaying 'SPRING ST' in large, bold, black capital letters. Below it, in smaller black capital letters, it reads 'ON STREET PARKING ON THIS SIDE ONLY'. The sign is positioned over the street, and the surrounding area shows buildings and parked cars.

6.5' SIDEWALK

Install curb extension

Install new crosswalks and ADA ramps

Extend median

SCALE

10 0 10

(IN FEET)
1 inch = 10 ft

PREPARED BY:

Sam Schwartz

NEW YORK • NEW JERSEY • CHICAGO
WASHINGTON D.C. • TAMPA • LOS ANGELES

322 EIGHTH AVENUE
5TH FLOOR
NEW YORK, NY 10001
P: (212) 598-9010 ~ FAX: (212) 598-9148

REVISIONS:

NO.	DATE	REMARKS	BY
			CHIEF

CLIENT:

HASTINGS-ON-HUDSON
7 MAPLE AVE
HASTINGS-ON-HUDSON, NY 10706

NOT APPROVED FOR CONSTRUCTION

PROJECT #: 17-01-2680
DRAWN BY: JC
CHECKED BY: JS
ORIGINAL DATE: 03-01-2018
DRAWING SCALE: 1"=20'
FILE NAME: 17-01-2680 Traffic Calming_Proposed
Updates - NEW6_recover.dwg

PROJECT:

ON-CALL TRAFFIC ENGINEERING SERVICES

TOC#1
STREET SAFETY AND TRAFFIC
CALMING IMPROVEMENTS

PROFESSIONAL ENGINEER:

NEW YORK LICENSE NUMBER
NY BUSINESS AUTHORIZATION NO. 0010052

SHEET TITLE:
INTERSECTION OF MAPLE
AVENUE AND SPRING STREET
PROPOSED IMPROVEMETNS

DRAWING NO.	TC-17
SHEET NO.	17 OF 19

REVISION 1

FOR PLANNING PURPOSES ONLY
NOT FOR DESIGN OR CONSTRUCTION

18417024PM cspeople
 TB REQ 10-26-2016 18417024PM cspeople
 \AWD002\PROJECTS\17-01-2680 HASTINGS-ON-HUDSON TRAFFIC ENGINEERING SERVICES\GRAPHICS\CAD FILES\17-01-2680 TRAFFIC CALMING PROPOSED UPDATES - NEW6 RECOVER >>>> LAYOUT: 16

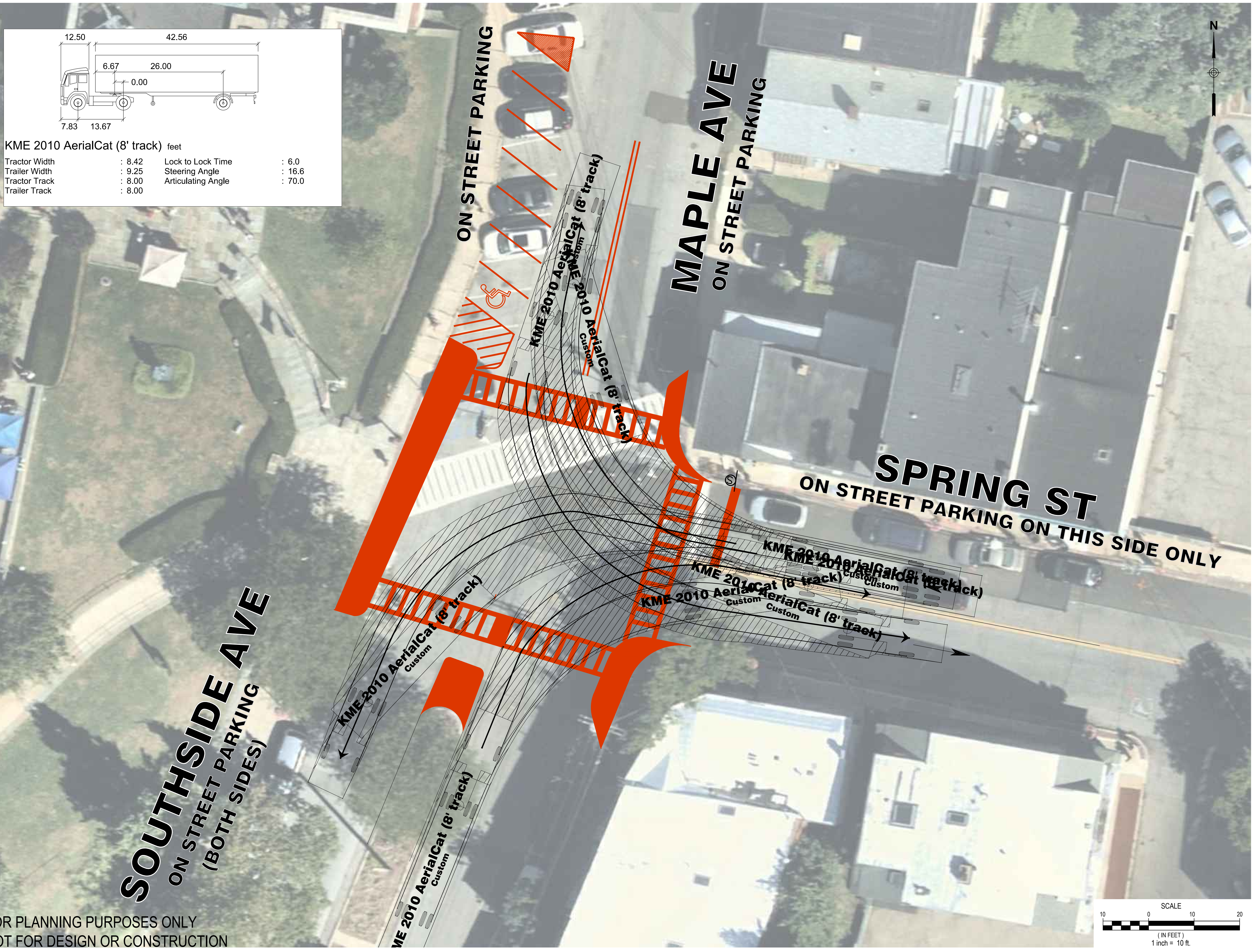
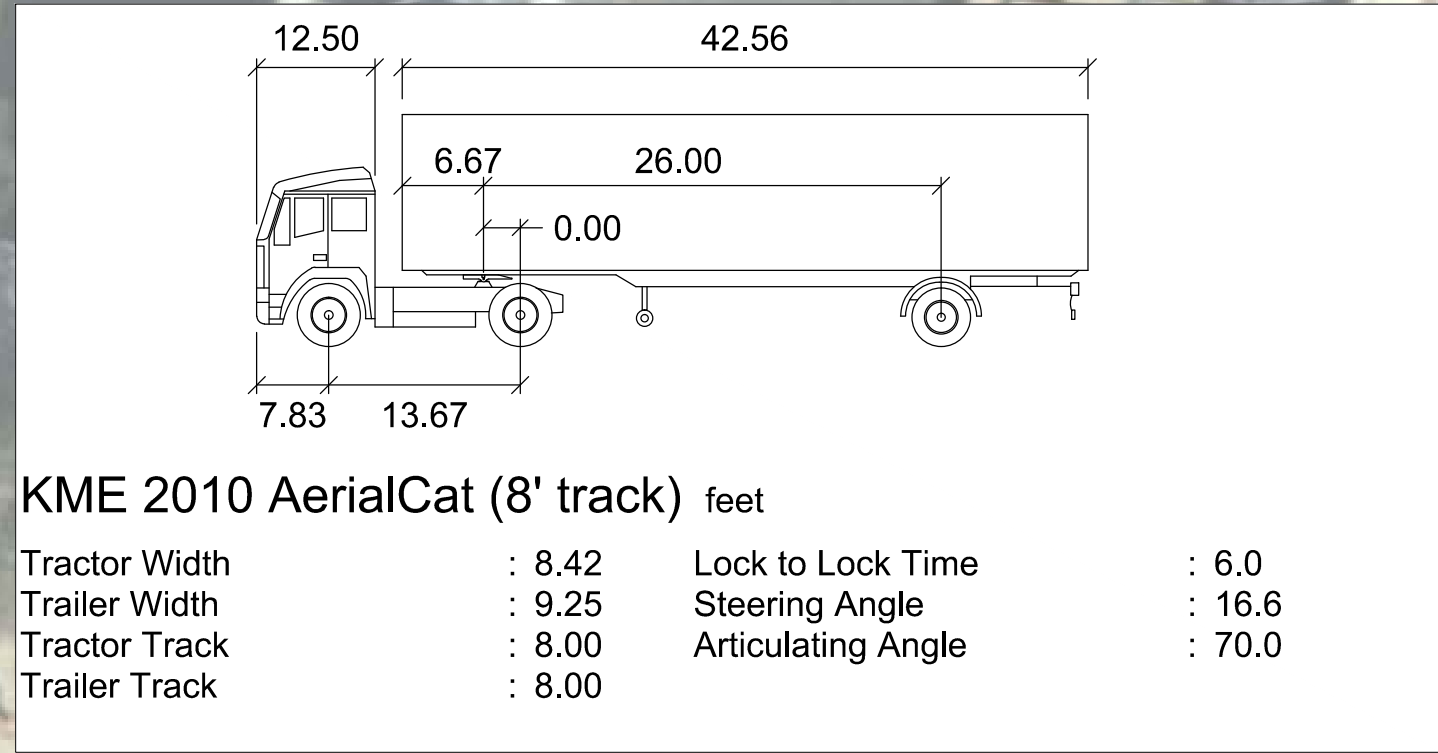

FOR PLANNING PURPOSES ONLY
NOT FOR DESIGN OR CONSTRUCTION

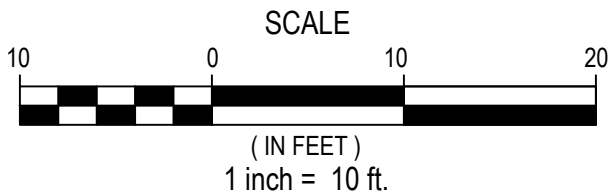

PREPARED BY:



NEW YORK • NEW JERSEY • CHICAGO
WASHINGTON D.C. • TAMPA • LOS ANGELES

322 EIGHTH AVENUE
5TH FLOOR
NEW YORK, NY 10001
P: (212) 598-9010 ~ FAX: (212) 598-9148

REVISIONS:

NO.	DATE	REMARKS	BY CHK

CLIENT:

HASTINGS-ON-HUDSON
7 MAPLE AVE
HASTINGS-ON-HUDSON, NY 10706

NOT APPROVED FOR CONSTRUCTION

PROJECT # : 17-01-2680
DRAWN BY: JC
CHECKED BY: JS
ORIGINAL DATE: 03-01-2018
DRAWING SCALE: 1"=20'
FILE NAME: 17-01-2680 Traffic Calming_Proposed Updates - NEW6_recover.dwg

PROJECT:

ON-CALL TRAFFIC
ENGINEERING SERVICES

TOC#1
STREET SAFETY AND TRAFFIC
CALMING IMPROVEMENTS

PROFESSIONAL ENGINEER:

NEW YORK LICENSE NUMBER
NY BUSINESS AUTHORIZATION NO. 0010052

SHEET TITLE:
INTERSECTION OF MAPLE
AVENUE AND SPRING STREET
FIRE TRUCK TURNS

DRAWING NO. TC-18
SHEET NO. 18 OF 19

REVISION 1

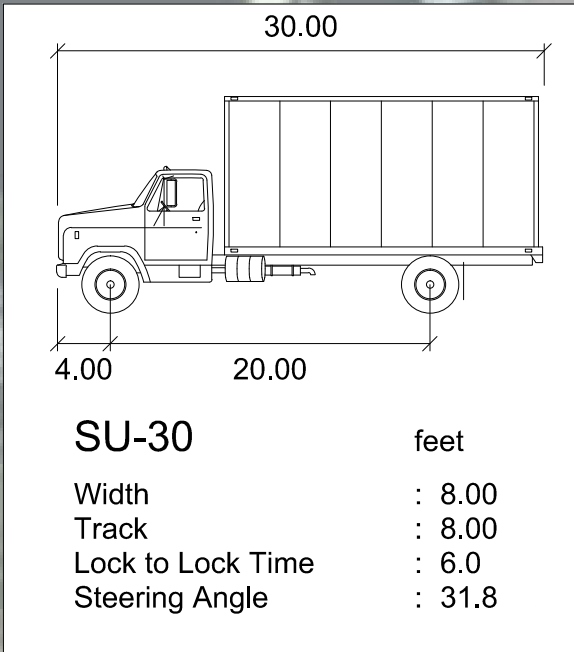

SOUTHSIDE AVE
ON STREET PARKING
(BOTH SIDES)

ON STREET PARKING

MAPLE AVE
ON STREET PARKING

SPRING ST
ON STREET PARKING ON THIS SIDE ONLY

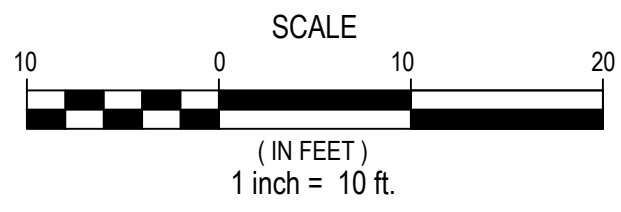
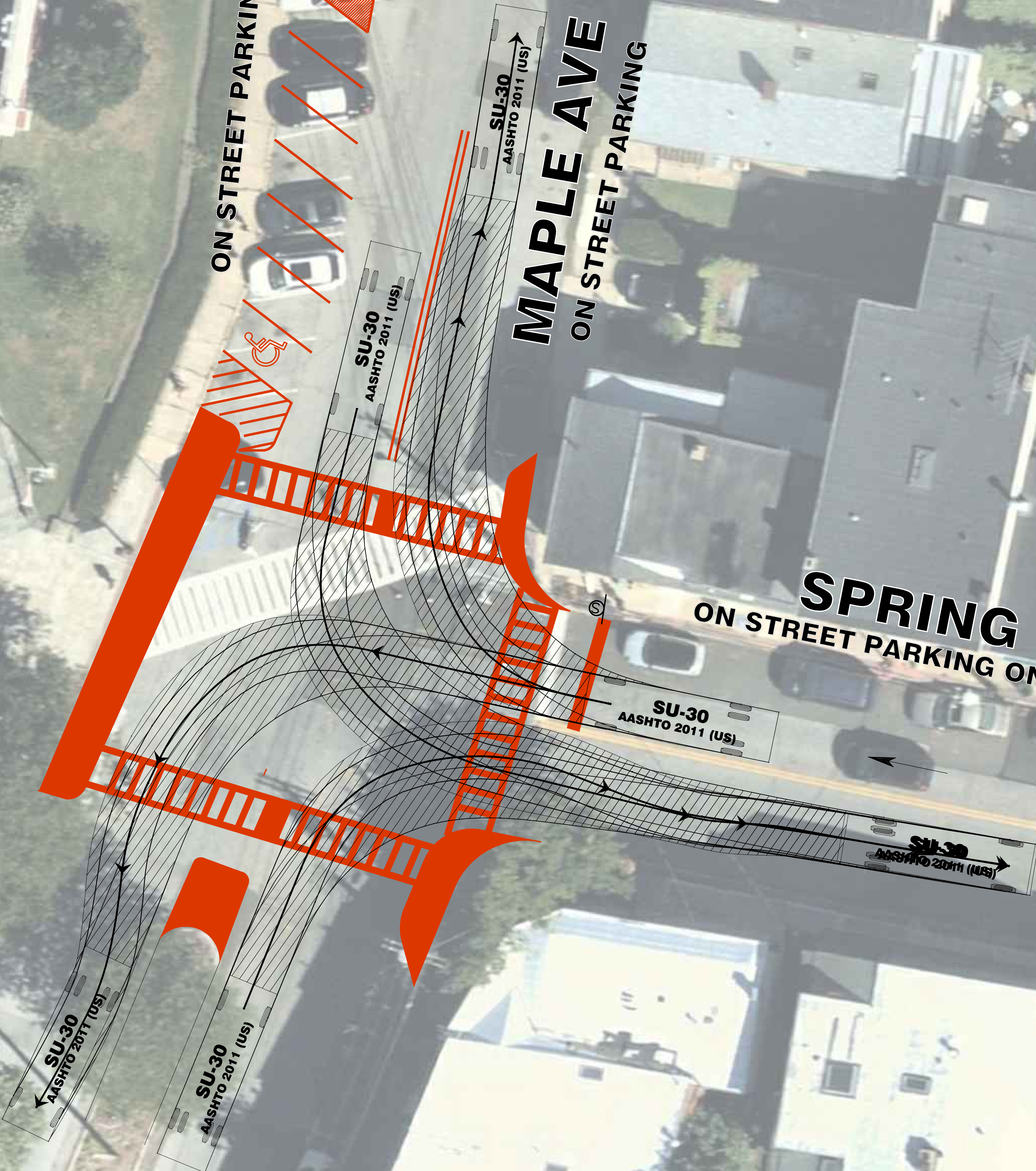

FOR PLANNING PURPOSES ONLY
NOT FOR DESIGN OR CONSTRUCTION

PREPARED BY:



NEW YORK • NEW JERSEY • CHICAGO
WASHINGTON D.C. • TAMPA • LOS ANGELES

322 EIGHTH AVENUE
5TH FLOOR
NEW YORK, NY 10001
P: (212) 598-9010 ~ FAX: (212) 598-9148

REVISIONS:

NO.	DATE	REMARKS	BY CHK

CLIENT:

HASTINGS-ON-HUDSON
7 MAPLE AVE
HASTINGS-ON-HUDSON, NY 10706

NOT APPROVED FOR CONSTRUCTION

PROJECT # : 17-01-2680
DRAWN BY: JC
CHECKED BY: JS
ORIGINAL DATE: 03-01-2018
DRAWING SCALE: 1"=20'
FILE NAME: 17-01-2680 Traffic Calming_Proposed Updates - NEW6_recover.dwg

PROJECT:

ON-CALL TRAFFIC
ENGINEERING SERVICES

TOC#1
STREET SAFETY AND TRAFFIC
CALMING IMPROVEMENTS

PROFESSIONAL ENGINEER:

NEW YORK LICENSE NUMBER
NY BUSINESS AUTHORIZATION NO. 0010052

SHEET TITLE:
INTERSECTION OF MAPLE
AVENUE AND SPRING STREET
SU-30 TRUCK TURNS

DRAWING NO. TC-19
SHEET NO. 19 OF 19

REVISION 1

17-REV 17-01-26-2018 15/01/24/NEW 17-01-2680 HASTINGS-ON-HUDSON TRAFFIC ENGINEERING SERVICES (GRAPHICS CO. FILES) 17-01-2680 TRAFFIC CALMING, PROPOSED IMPROVEMENTS - NEW6_RECOVER.dwg 18