

Existing Site Plan

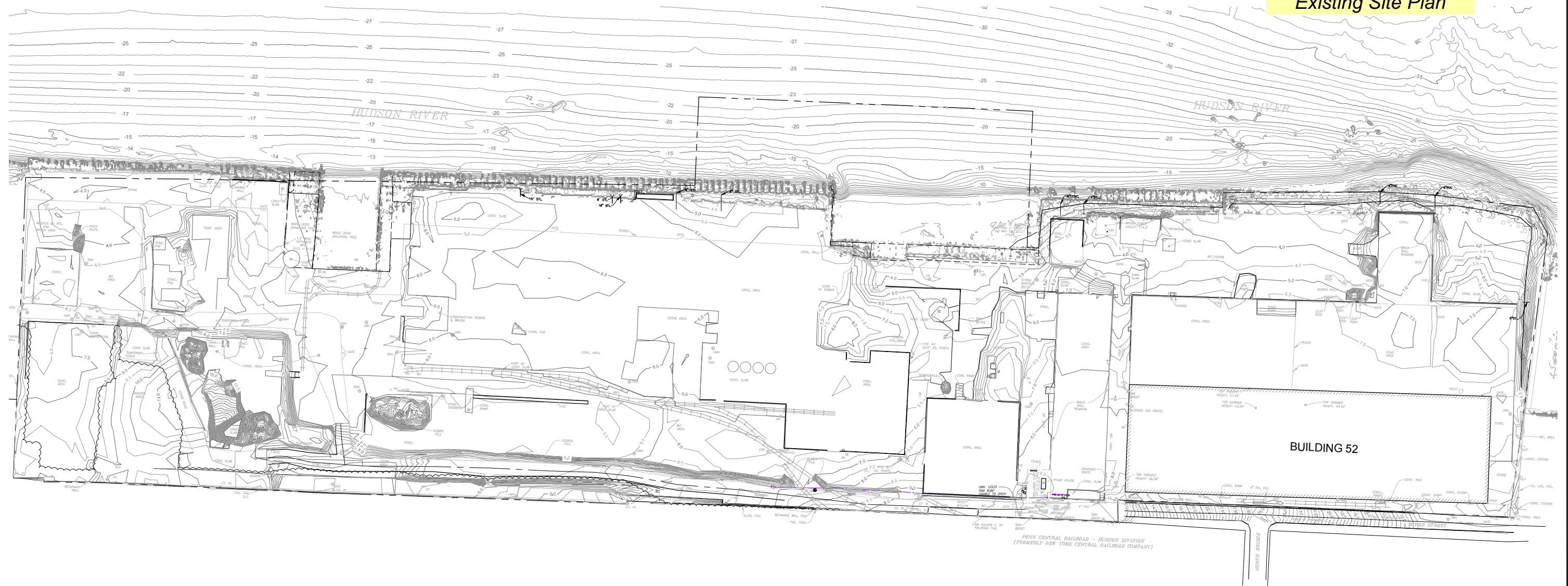

**DRAFT**

*Preliminary Site Plan  
based on the Consent  
Decree and ROD*

Approx. Sloped Shoreline  
Sloped up to El. +11 ft

Developable  
Portion of the Site  
El. +11 ft

*Developable Portion of the Site with Final grad contour line at +11 ft except Sloped Shoreline Northwest Corner, and Transition Areas.*

*Areas depicted are approximate and subject to change based on the Remedial Design and potential on-site mitigation.*

## Extension

## Northwest Corner

## BUILDING 5